

## Cromar Building Products Ltd

Units 3, 4, 5 Northside Industrial Park  
Whitley Bridge  
N Yorkshire DN14 0GH

Tel: 01977 663 133 Fax: 01977 662 186

e-mail: sales@cromar.uk.com

website: www.cromar.uk.com



### Agrément Certificate

18/5546

Product Sheet 5

## CROMAR GRP VALLEY TROUGH AND FLASHINGS RANGE

### CROMAR PRO VALLEY GRP ABUTMENT SECRET GUTTER/SOAKER (GAS 1)

This Agrément Certificate Product Sheet<sup>(1)</sup> relates to Cromar Pro Valley GRP Abutment Secret Gutter/Soaker (GAS 1), for use in slated/tiled roofs constructed in accordance with the relevant requirements of BS 5534 : 2014.

(1) Hereinafter referred to as 'Certificate'.

#### CERTIFICATION INCLUDES:

- factors relating to compliance with Building Regulations where applicable
- factors relating to additional non-regulatory information where applicable
- independently verified technical specification
- assessment criteria and technical investigations
- design considerations
- installation guidance
- regular surveillance of production
- formal three-yearly review.

#### KEY FACTORS ASSESSED

**Weathertightness** — as part of a complete roof, the product will resist the passage of moisture into the interior of the building (see section 6).

**Properties in relation to fire** — the product can contribute towards a roof being unrestricted under the national Building Regulations (see section 7).

**Strength** — the product has adequate strength to resist the normal loads and impacts associated with installation of a roof (see section 8).

**Durability** — under normal service conditions, the product will have a service life in excess of 20 years (see section 10).



The BBA has awarded this Certificate to the company named above for the product described herein. This product has been assessed by the BBA as being fit for its intended use provided it is installed, used and maintained as set out in this Certificate.

On behalf of the British Board of Agrément

Date of Second issue: 25 February 2021  
Originally certificated on 18 September 2018

Hardie Giesler  
Chief Executive Officer

*The BBA is a UKAS accredited certification body – Number 113.*

*The schedule of the current scope of accreditation for product certification is available in pdf format via the UKAS link on the BBA website at [www.bbacerts.co.uk](http://www.bbacerts.co.uk)  
Readers MUST check the validity and latest issue number of this Agrément Certificate by either referring to the BBA website or contacting the BBA directly.*

*Any photographs are for illustrative purposes only, do not constitute advice and should not be relied upon.*

#### British Board of Agrément

Bucknalls Lane  
Watford  
Herts WD25 9BA

©2021

tel: 01923 665300  
[clientservices@bbacerts.co.uk](mailto:clientservices@bbacerts.co.uk)  
[www.bbacerts.co.uk](http://www.bbacerts.co.uk)

## Regulations

In the opinion of the BBA, Cromar Pro Valley GRP Abutment Secret Gutter/Soaker (GAS 1), if installed, used and maintained in accordance with this Certificate, can satisfy or contribute to satisfying the relevant requirements of the following Building Regulations (the presence of a UK map indicates that the subject is related to the Building Regulations in the region or regions of the UK depicted):



### The Building Regulations 2010 (England and Wales) (as amended)

<b>Requirement:</b>	<b>B4(2)</b>	<b>External fire spread</b>
Comment:	The product can contribute towards a roof being unrestricted under this Requirement. See section 7 of this Certificate.	
<b>Requirement:</b>	<b>C2(b)</b>	<b>Resistance to moisture</b>
Comment:	The product will contribute to a roof satisfying this Requirement. See section 6 of this Certificate.	
<b>Regulation:</b>	<b>7(1)</b>	<b>Materials and workmanship</b>
Comment:	The product is acceptable. See section 10 and the <i>Installation</i> part of this Certificate.	



### The Building (Scotland) Regulations 2004 (as amended)

<b>Regulation:</b>	<b>8(1)(2)</b>	<b>Durability, workmanship and fitness of materials</b>
Comment:	The use of the product satisfies the requirements of this Regulation. See sections 9 and 10 and the <i>Installation</i> part of this Certificate.	
<b>Regulation:</b>	<b>9</b>	<b>Building standards applicable to construction</b>
Standard:	<b>2.8</b>	Spread from neighbouring buildings
Comment:	The product can be regarded as having low vulnerability with reference to clause 2.8.1 <sup>(1)(2)</sup> of this Standard, and will not affect the fire rating of the roof construction. See section 7 of this Certificate.	
Standard:	<b>3.10</b>	Precipitation
Comment:	The product will enable a roof to satisfy the requirements of this Standard with reference to clauses 3.10.1 <sup>(1)(2)</sup> and 3.10.8 <sup>(1)(2)</sup> . See section 6 of this Certificate.	
Standard:	<b>7.1(a)(b)</b>	Statement of sustainability
Comment:	The product can contribute to satisfying the relevant requirements of Regulation 9, Standards 1 to 6, and therefore will contribute to a construction meeting a bronze level of sustainability as defined in this Standard.	
<b>Regulation:</b>	<b>12</b>	<b>Building standards applicable to conversions</b>
Comment:	Comments in relation to the product under Regulation 9, Standards 1 to 6, also apply to this Regulation, with reference to clause 0.12.1 <sup>(1)(2)</sup> and Schedule 6 <sup>(1)(2)</sup> .	

(1) Technical Handbook (Domestic).

(2) Technical Handbook (Non-Domestic).



### The Building Regulations (Northern Ireland) 2012 (as amended)

<b>Regulation:</b>	<b>23(a)(i)</b>	<b>Fitness of materials and workmanship</b>
Comment:	<b>(iii)(b)(i)</b>	The product is acceptable. See section 10 and the <i>Installation</i> part of this Certificate.
<b>Regulation:</b>	<b>28(b)</b>	<b>Resistance to moisture and weather</b>
Comment:	The product will enable a roof to satisfy the requirements of this Regulation. See section 6 of this Certificate.	

**Regulation:** 36(b) External fire spread

**Comment:** The product can contribute towards a roof being unrestricted under this Regulation. See section 7 of this Certificate.

## Construction (Design and Management) Regulations 2015

## Construction (Design and Management) Regulations (Northern Ireland) 2016

Information in this Certificate may assist the client, designer (including Principal Designer) and contractor (including Principal Contractor) to address their obligations under these Regulations.

See sections: 1 *Description* (1.2) and 3 *Delivery and site handling* (3.1) of this Certificate.

### Additional Information

#### NHBC Standards 2021

In the opinion of the BBA, Cromar Pro Valley GRP Abutment Secret Gutter/Soaker (GAS 1), if installed, used and maintained in accordance with this Certificate, can satisfy or contribute to satisfying the relevant requirements in relation to *NHBC Standards*, Chapter 7.2 *Pitched roofs*.

### Technical Specification

#### 1 Description

1.1 Cromar Pro Valley GRP Abutment Secret Gutter/Soaker (GAS 1) is a glass fibre/polyester laminate, with a UV-resistant polyester film on the upper face (see Figures 1 and 2) and a sanded strip bonded along the upper surface to provide a key for bedding the roof tiles into mortar.

Figure 1 Cromar Pro Valley GRP Abutment Secret Gutter/Soaker (GAS 1)

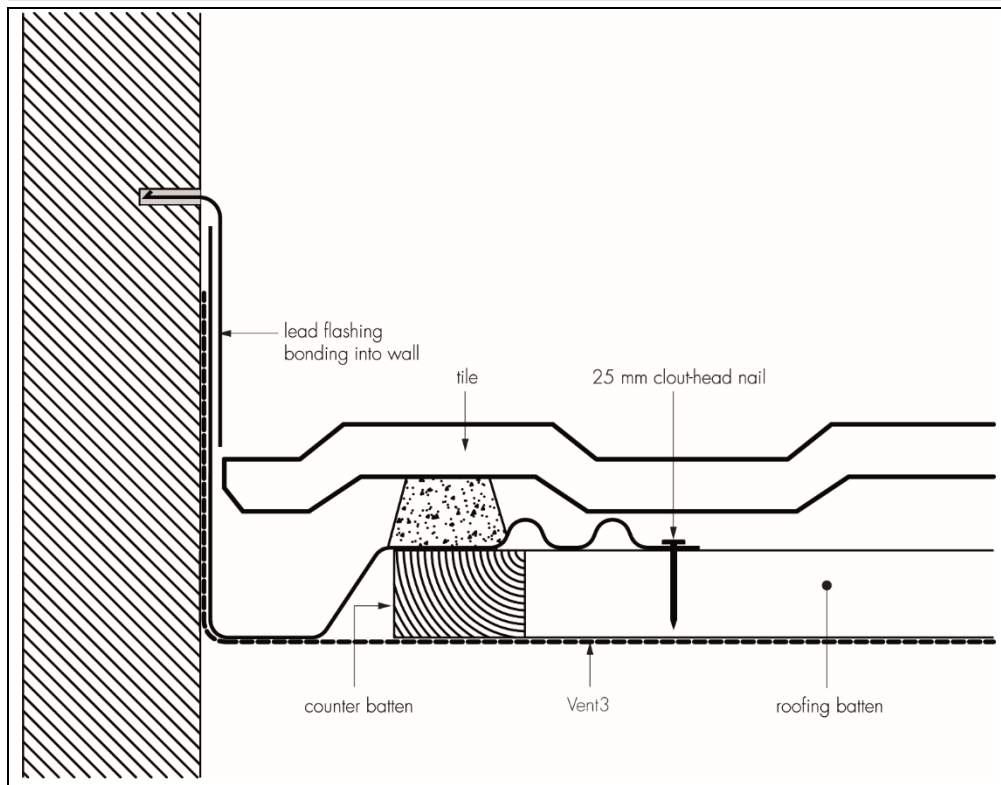

*Figure 2 Cromar Pro Valley GRP Abutment Secret Gutter/Soaker (GAS 1) with slate roof application*

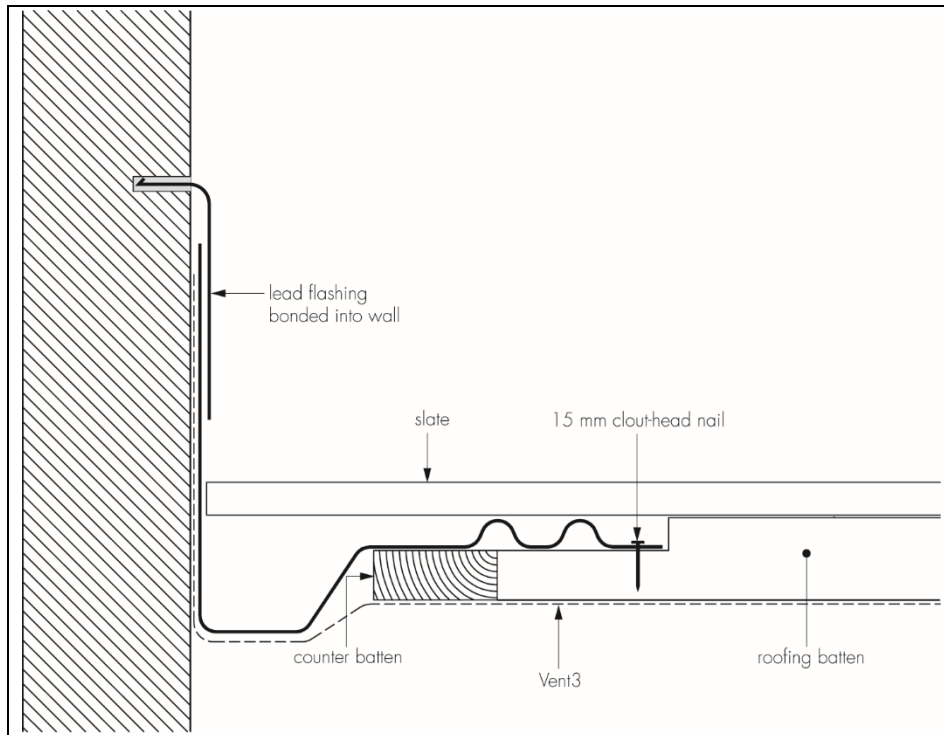

1.2 The profile is supplied in lengths of 3 m, with a width of 140 mm.

1.3 The product is finished in a lead grey colour.

## 2 Manufacture

2.1 Glass fibre strands are impregnated with resin and formed into a laminate, with a polyester carrier film and a weather protection film. The required profile is shaped by wooden formers and allowed to cure.

2.2 As part of the assessment and ongoing surveillance of product quality, the BBA has:

- agreed with the manufacturer the quality control procedures and product testing to be undertaken
- assessed and agreed the quality control operated over batches of incoming materials
- monitored the production process and verified that it is in accordance with the documented process
- evaluated the process for management of nonconformities
- checked that equipment has been properly tested and calibrated
- undertaken to carry out the above measures on a regular basis through a surveillance process, to verify that the specifications and quality control operated by the manufacturer are being maintained.

## 3 Delivery and site handling

3.1 The product is distributed in packs of 10 units, each unit marked with the application and the BBA logo incorporating the number of this Certificate.

3.2 The packs should be stored flat or on end, on a smooth, clean, dry surface, under cover and protected from sunlight.

## Assessment and Technical Investigations

The following is a summary of the assessment and technical investigations carried out on Cromar Pro Valley GRP Abutment Secret Gutter/Soaker (GAS 1).

## Design Considerations

### 4 Use

Cromar Pro Valley GRP Abutment Secret Gutter/Soaker (GAS 1), when designed and installed in accordance with the relevant parts of BS 5534 : 2014, BS 8000-0 : 2014 and BS 8000-6 : 2013, is satisfactory for use as a secret gutter in slated or tiled pitched roofs to provide a weatherproof junction where a wall abuts the roof.

### 5 Practicability of installation

The product is designed to be installed by roofers experienced with this type of product.

### 6 Weathertightness



The product will adequately resist the passage of moisture into the interior of the building and so satisfy the requirements of the national Building Regulations.

### 7 Properties in relation to fire



Samples of glass-reinforced plastic (GRP), representative of that used in the manufacture of the product, when tested in accordance with BS 476-3 : 2004, achieved an EXT.S.AA rating.

### 8 Strength

The product will resist the normal loads and impacts associated with installation and use.

### 9 Maintenance



Minimal maintenance is necessary, and the smooth finish will restrict and inhibit mould and fungal growth.

### 10 Durability



The product, when subjected to normal conditions of exposure and use, will have a service life in excess of 20 years.

## Installation

### 11 General

Installation of Cromar Pro Valley GRP Abutment Secret Gutter/Soaker (GAS 1) must be in accordance with the Certificate holder's instructions and the relevant recommendations of BS 5534 : 2014, BS 8000-0 : 2014 and BS 8000-6 : 2013.

### 12 Procedure

12.1 The roof is covered with underlay as in normal practice, with the underlay finished and turned up approximately 100 mm at abutting walls.

- 12.2 Roofing battens must be cut short of the abutment wall to allow a 50 mm gap between the wall and the counter batten.
- 12.3 For slates, the roofing batten must be routed to a depth of 10 mm to allow the top of the water bars to be at the same level as the rest of the roof battens. The counter batten must be sized to match the reduced depth (see Figure 2).
- 12.4 Noggins may need to be fixed flush to the top of the rafters to anchor the roof battens and the counter battens.
- 12.5 Fixing of the abutment secret gutter commences at its foot, using 25 mm clout-headed nails at maximum 500 mm centres onto the roofing battens for tiled applications or 15 mm clout nails for slate roof applications.
- 12.6 Consecutive lengths of abutment secret gutters are laid, dressed to shed water down the slope, allowing a minimum 150 mm overlap (when measured vertically) at the joints.
- 12.7 The use of double slates/tiles is advisable, to eliminate the possibility of small sections requiring fixing.
- 12.8 The slates are laid in the normal manner, ensuring they are flush to the abutment flashing.
- 12.9 Where tiles are used, these are bedded onto mortar which is applied onto the sanded strip running longitudinally along the length of the product. It may be necessary to break off the nibs of concrete tiles to eliminate kick-up.
- 12.10 Code 4 lead stepped flashing is used to dress over the abutment flashing upstand.
- 12.11 Trimming of the fascia board may be required to allow water to be discharged into the gutter. Alternatively, a tilt fillet and lead saddle/outlet can be incorporated.

## 13 Finishing

The roof slating/tiling must be carried out in accordance with the relevant parts of BS 5534 : 2014, BS 8000-0 : 2014 and BS 8000-6 : 2013.

## 14 Repair

Damaged lengths can be replaced without having to remove adjacent lengths.

## Technical Investigations

## 15 Tests

Tests were carried out and the results assessed to determine:

- density
- glass/resin ratio
- dimensional checks
- hardness
- cross-breaking strength
- tensile strength/elongation
- impact resistance
- effect of elevated temperatures
- effect of water soak
- effect of UV exposure.

## 16 Investigations

16.1 The manufacturing process was evaluated, including the methods adopted for quality control, and details were obtained of the quality and composition of the materials used.

16.2 An assessment was made of the results of a fire test in accordance with BS 476-3 : 2004.

## Bibliography

BS 476-3 : 2004 *Fire tests on building materials and structures — Classification and method of test for external fire exposure to roofs*

BS 5534 : 2014 + A2 : 2018 *Slating and tiling for pitched roofs and vertical cladding — Code of practice*

BS 8000-0 : 2014 *Workmanship on construction sites — Part 0 : Introduction and general principles*

BS 8000-6 : 2013 *Workmanship on building sites — Code of practice for slating and tiling of roofs and walls*

### 17 Conditions

#### 17.1 This Certificate:

- relates only to the product/system that is named and described on the front page
- is issued only to the company, firm, organisation or person named on the front page – no other company, firm, organisation or person may hold or claim that this Certificate has been issued to them
- is valid only within the UK
- has to be read, considered and used as a whole document – it may be misleading and will be incomplete to be selective
- is copyright of the BBA
- is subject to English Law.

17.2 Publications, documents, specifications, legislation, regulations, standards and the like referenced in this Certificate are those that were current and/or deemed relevant by the BBA at the date of issue or reissue of this Certificate.

17.3 This Certificate will remain valid for an unlimited period provided that the product/system and its manufacture and/or fabrication, including all related and relevant parts and processes thereof:

- are maintained at or above the levels which have been assessed and found to be satisfactory by the BBA
- continue to be checked as and when deemed appropriate by the BBA under arrangements that it will determine
- are reviewed by the BBA as and when it considers appropriate.

17.4 The BBA has used due skill, care and diligence in preparing this Certificate, but no warranty is provided.

17.5 In issuing this Certificate the BBA is not responsible and is excluded from any liability to any company, firm, organisation or person, for any matters arising directly or indirectly from:

- the presence or absence of any patent, intellectual property or similar rights subsisting in the product/system or any other product/system
- the right of the Certificate holder to manufacture, supply, install, maintain or market the product/system
- actual installations of the product/system, including their nature, design, methods, performance, workmanship and maintenance
- any works and constructions in which the product/system is installed, including their nature, design, methods, performance, workmanship and maintenance
- any loss or damage, including personal injury, howsoever caused by the product/system, including its manufacture, supply, installation, use, maintenance and removal
- any claims by the manufacturer relating to CE marking.

17.6 Any information relating to the manufacture, supply, installation, use, maintenance and removal of this product/system which is contained or referred to in this Certificate is the minimum required to be met when the product/system is manufactured, supplied, installed, used, maintained and removed. It does not purport in any way to restate the requirements of the Health and Safety at Work etc. Act 1974, or of any other statutory, common law or other duty which may exist at the date of issue or reissue of this Certificate; nor is conformity with such information to be taken as satisfying the requirements of the 1974 Act or of any statutory, common law or other duty of care.