

A SIKA COMPANY



ROOFING PRODUCTS

Acrypol Flexiglass is a versatile GRP resin roof system designed for new and existing roofs. Flexiglass can be applied to almost any roof surface such as felt, asphalt, concrete and OSB3 TG board as a new roof covering. Flexiglass is a totally seamless, highly flexible roof system ideal for any sized job.

**Broof
(t4)**

EN 13501-5



FLEXIGLASS RESIN.

A pre-promoted thixotropic polyester flexible resin designed specifically for overlay roofing applications.

Size:	Plt. Qty:	Prod. Codes:
20kg	36	G20/FLEXITC20



FLEXIGLASS PRIMER.

Pre-promoted, low viscosity, thixotropic, polyester flexible primer designed specifically for overlay roofing application enabling an outstanding bond to multiple substrates.

Size:	Plt. Qty:	Prod. Codes:
5kg	120	G20/FLEXIPRIMER5



FLEXIGLASS GRP Roofing System

Acrypol Flexiglass is a versatile GRP resin roof system designed for new and existing roofs.

NEW DECK	OVERLAY	WARRANTY (YEARS)	LIFE EXPECTANCY (YEARS)	TRADE / PROFESSIONAL USE	DIY USE	SUBSTRATES	BASE	PRIMER REQUIRED	REINFORCEMENT	TRAINING
		20*	20+			Most common roofing substrates	SOLVENT			



Resin
1.7kg/m²

Primer
500g



Web page link

FLEXIGLASS MATTING.

Part of the Flexiglass system, the 225gsm fibreglass matting is sandwiched between two layers of Flexiglass resin.

Size:

33Kg

16.5Kg

6.75Kg

Prod. Codes:

GMATTECH/225/33

GMATTECH/225/16.5

GMATTECH/225/6.75

JOINTING BANDAGE.

The jointing bandage is used to tape joints and seams on a Flexiglass roof. The strands of the glassfibre are held together by an emulsion binder to form a mat.

Size:

50m x 75mm

Prod. Codes:

GMAT/225BAN

FLEXIGLASS CATALYST.

Catalyst is the primary component of any fibreglass flat roofing system.

Size:

50g

100g

200g

Box Qty:

250

125

60

Prod. Codes:

G20/BPO50

G20/BPO100

G20/BPO200

20 Year
Manufacturers
Product
Warranty*

Subject to terms and conditions.

Flexible GRP for all types of common roofing substrates

One resin for both Base & Topcoat

Quick cure Primer

Uses a 225G Chopped Strand Matting for the ultimate in flexibility

Health & Safety conscious Catalyst with easy application

Suitable for both new decks & refurbishment projects

Superior Adhesion

Unaffected by direct sunlight

PROGRP®

ADVANCED GLASSFIBRE ROOFING SYSTEM

We have developed this technology further to produce the perfect all weather protection for any flat roof. **PRO GRP** can be applied in small domestic situations right through to large industrial environments.

Broof
(t4)

EN 13501-5



GRP FINISHING TISSUE.

The finishing tissue is for neat finishes on visible moulded corners and tidying up details on roof penetrations.

Size:	Box Qty:	Prod. Codes:
100mm x 250m	10	GTISH



PRO GRP TOP COAT.

Part of the PRO GRP Roofing System, the top coat is brush or roller applied, cold applied and fully bonds to the roof membrane to form a complete system.

Size:	Pallet Qty:	Product Codes:
10kg	48	G25/TOP10FR
20kg	36	G25/TOP20FR



PRO GRP RESIN.

Cold applied and easy to form around complex situations, durable and able to resist foot traffic PRO GRP resin is an essential component in the roofing system.

Size:	Pallet Qty:	Product Codes:
10kg	48	G25/RES10
20kg	36	G25/25RESIN20

PRO GRP Roofing System

PRO GRP can be applied in small domestic situations right through to large industrial environments.

NEW DECK	OVERLAY	WARRANTY (YEARS)	LIFE EXPECTANCY (YEARS)	TRADE / PROFESSIONAL USE	DIY USE	SUBSTRATES	BASE	PRIMER REQUIRED	REINFORCEMENT	TRAINING
		25*	25+			Most common roofing substrates	SOLVENT			



Web page link

GLASS FIBRE JOINTING BANDAGE.

The jointing bandage is used to tape joints and seams on GRP roofs. The strands of the glassfibre are held together by an emulsion binder to form a mat.

Size: 100mm x 75m
Box Qty: 10
Prod. Codes: **GB/ROLL**

PRO GRP HARDENER.

General purpose MEKP gives consistent curing of unsaturated polyester resins and topcoats.

Size: 1kg, 5kg
Box Qty: 12, 1
Prod. Codes: **GH/1**, **GH/5**

GLASS FIBRE MATTING.

Part of the PRO GRP Glassfibre roofing system, the fibreglass matting is sandwiched between two layers of PRO GRP Resin.

Size: 6.5kg, 16.5kg, 33kg / 450gsm, 33kg / 600gsm
Pallet Qty: 48, 25, 16, 16
Product Codes: **GMAT/15**, **GMAT/16.5**, **GMAT/35**, **GMAT/35600**

PROGRP ROOFING KIT.

A handy kit containing everything required to install PROGRP for a 13 sqm* roof**.

Size: 13m²*
Prod. Codes: **GRP/KIT13B**

* Coverage is approximate
** Trims Sold separately

CONTRACTOR GRADE RESIN & TOPCOAT .

Product:	Size:	Pallet Qty:	Product Codes:
Contractor Resin	10kg	48	G25/RES10C
Contractor Resin	20kg	36	G25/RES20C
Contractor TopCoat	10kg	48	G25/TOP10C
Contractor TopCoat	20kg	36	G25/TOP20C



25 Year
Manufacturers
Product
Warranty*

Subject to terms and conditions

COLD APPLIED
no heat required

EASY TO FORM
around complex situations

VERY DURABLE
resists heavy foot traffic

NON-SLIP WALKWAYS
can be incorporated

CLASS LEADING ROOFING SOLUTION
that far exceeds traditional methods

VIRTUALLY MAINTENANCE FREE
for very long periods of time

IMPACT RESISTANT
due to its ultra hard finish

FIRE RETARDANT

HIGHLY ECONOMICAL SOLUTION

GRP TRIMS & ACCESSORIES

D TRIM

WALL FILLET TRIM.

Size: 100mm
Box Qty: 10
Prod.Code:
[GD260/RSAT-1](#)

WALL FILLET TRIM.

Size: 170mm
Box Qty: 10
Prod.Code:
[GD300](#)

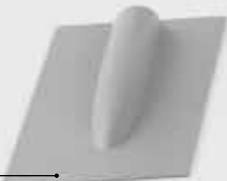

C5 LARGE ROOF RIDGE CLOSURE E280.

Box Qty: 1
Prod.Code:
[GA/C5](#)

INTERNAL RAISED ANGLE TRIM.

Box Qty: 10
Prod.Codes for 195 INT:
[GINT/195/RS/INT](#)

EXTERNAL RAISED ANGLE TRIM.

Box Qty: 10
Prod.Codes for 195 EXT:
[GEXT/195.RS/INT](#)

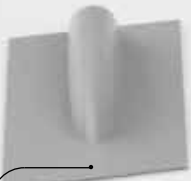

C6 SMALL ROOF RIDGE CLOSURE.

Box Qty: 1
Prod.Code:
[GA/C6](#)

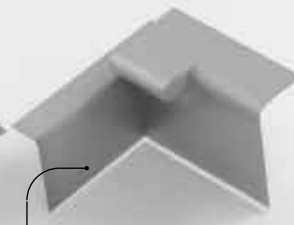

B TRIM

RAISED EDGE TRIMS.

Box Qty: 10
105mm
Prod.Codes:
[GB230/RSRT-1](#)

127mm
Prod.Codes:
[GB260/RSRT-2](#)

177mm
Prod.Codes:
[GB300](#)

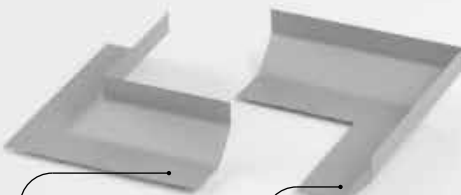

C3 EXTERNAL FILLET CORNER.

Box Qty: 1
Prod.Code:
[GA/C3EXT](#)

C3 INTERNAL FILLET CORNER.

Box Qty: 1
Prod.Code:
[GA/C3INT](#)

A TRIM

DRIP TRIMS.

Box Qty: 10
60mm
Prod.Codes:
[GA170](#)

90mm
Prod.Codes:
[GA200/RSdT-1](#)

141mm
Prod.Codes:
[GA250/RSdT-2](#)

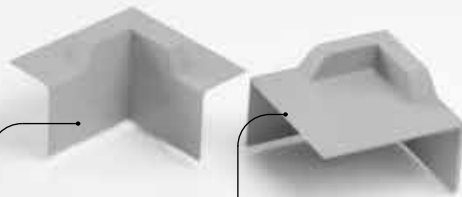

C1 EXTERNAL CORNER.

Box Qty: 1
Prod.Code:
[GA/C1](#)

C4 INTERNAL CORNER.

Box Qty: 1
Prod.Code:
[GA/C4](#)

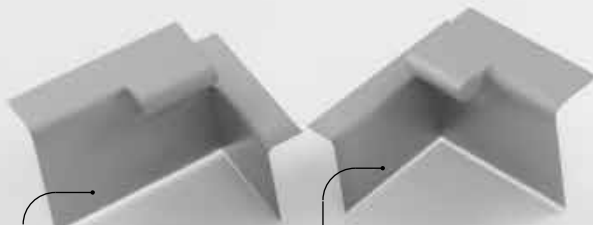

C2 FILLET TO TRIM LEFT CORNER.

Box Qty: 1
Prod.Code:
[GA/C2](#)

C2 FILLET TO TRIM RIGHT CORNER.

Box Qty: 1
Prod.Code:
[GA/C2R](#)

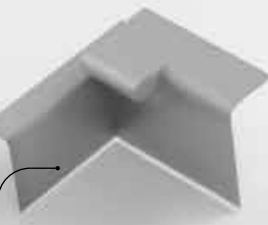

Sikaflex® EBT+

A multi-purpose, permanently- elastic, one-part, polyurethane adhesive and sealant. Sikaflex® EBT+ bonds to all common building materials; its excellent grab and gap filling properties makes it ideal for use in a wide range of building and maintenance applications.

Compatible as a trim adhesive for the Cromar GRP Trims.

Sikaflex® EBT+

SGAN	SIZE	COLOUR	QTY	BARCODE
511392	300ml	White	12	7612894368475
511394	300ml	Black	12	7612894368437
511397	300ml	Concrete Grey	12	7612894368451
840705	600 ml	Concrete Grey	20	7612655118967

Please note: Colours shown against products are simply a representation and are not exact due to limitations of print processes. For exact colours please request samples.



Web page link



RAINWATER OUTLET FOR INTERNAL DRAIN 4".

Box Qty: 1
Prod.Code:
GA/7116

**PIPE COLLAR
RAINWATER OUTLET 2".**

Box Qty: 1
Prod.Code:
GA/117

**THROUGH WALL
PARAPET OUTLET.**

Box Qty: 1
Prod.Code:
GA/7115

BRUSHES.

Box Qty: 12
Prod.Codes:
2" - **GPB/2**
3" - **GPB/3**
4" - **GPB/4**

F TRIM

C TRIM

E TRIM

F300 FLAT SHEET.

Box Qty: 1x20m
Prod.Code:
GF300

**C100
SIMULATED
LEAD FLASHING.**

Box Qty: 10
Prod.Code:
GC100/RSLT-1

**E280
EXPANSION
JOINT.**

Box Qty: 10
Prod.Code:
GEXP

LAMINATING ROLLERS.

21mm width / Box Qty: 10
Prod.Codes:
70mm - **GBB/70**
140mm - **GBB/140**
225mm - **GBB/225**
45mm width / Box Qty: 5
Prod.Codes:
225mm - **GBB/225/40**

ROLLERS.

3" Roller / Box Qty: 10 Prod.Codes: GROLL/3	3" Refill / Box Qty: 20 Prod.Codes: GFILL/3
7" Roller / Box Qty: 6 Prod.Codes: GROLL/7	7" Refill / Box Qty: 6 Prod.Codes: GFILL/7
9" Roller / Box Qty: 6 Prod.Codes: GROLL/9	9" Refill / Box Qty: 6 Prod.Codes: GFILL/9



**PRO GRP
MIXING BUCKET.**

Size: 10L Box Qty: 1
Prod.Code:
EMPTYGRP/12.5



**CATALYST
DISPENSER.**

Size: 80ml
Box Qty: 50
Prod.Codes:
GDISP/80



ACETONE.

Solvent used for cleaning tools and areas contaminated with adhesives, polyesters, resins and other similar products.

Size:	Box Qty:	Prod.Code:
1L	12	GA/1
5L	4	GA/5
25L	1	GA/25

ACCESSORIES NOT
PICTURED:

WHITE TUB 10L.

Box Qty: 1
Prod.Code: **EMPTY/10**

WHITE TUB 5L.

Box Qty: 1
Prod.Code: **EMPTYT/501**

**GRADUATING BUCKET
14L.**

Box Qty: 1
Prod.Code: **GBUCK/10**

SCAN GRIT.

Size: 25kg
Prod.Code: **GSCAN/25**

Cromapol will waterproof instantly, even while wet, and will not wash off while curing. It is ideal for use in damp conditions. Will withstand ponding and covers in only one coat.

CROMAPOL.

A one coat, instant waterproof coating ideal for emergency repairs. With the ability to use in damp conditions it provides a flexible, seamless, reinforced membrane that gives instant protection.

Size:	Colour:	Box Qty:	Prod.Codes:
1kg	Grey	12	APOL/1F
2.5kg	Grey	6	APOL/2.5F
5kg	Grey	4	APOL/5
20kg	Grey	1	APOL/20
1kg	Black	12	APOLB/1F
2.5kg	Black	6	APOLB/2.5
5kg	Black	4	APOLB/5F
20kg	Black	1	APOLB/25
1kg	White	12	APOLW/1
2.5kg	White	6	APOLW/2.5
5kg	White	4	APOLW/5F
20kg	White	1	APOLW/25

CROMAPOL FIBRE FREE.

A fibre free, one coat, instant waterproof coating ideal for emergency repairs. With the ability to use in damp conditions it provides instant protection.

Size:	Colour:	Box Qty:	Prod.Codes:
5kg	Opaque	4	APOLTR/5
20kg	Opaque	1	APOLTR/20
5kg	Grey	4	APOLGP/5
20kg	Grey	1	APOLGP/20
5kg	White	4	APOLWP/5
20kg	White	1	APOLWP/20

CP PRIMER.

A vinyl acetate based primer specifically for priming mastic asphalt, concrete and asbestos surfaces prior to over-laying with Cromapol.

Size:	Box Qty:	Prod.Codes:
5L	4	ACPP/501
20L	1	ACPP/601

REINFORCEMENT SCRIM.

Used when extra reinforcement is required, for example cracks in corrugated asbestos, gutters, splits in felt and asphalt roofing.

Size:	Box Qty:	Prod.Codes:
1mx50m	1	QSC/50

CROMAPOL Acrylic Roof Coating

Cromapol will waterproof instantly, even while wet, and will not wash off while curing. It is ideal for use in damp conditions. Will withstand ponding and covers in only one coat.

NEW DECK	OVERLAY	WARRANTY (YEARS)	LIFE EXPECTANCY (YEARS)	TRADE / PROFESSIONAL USE	DIY USE	SUBSTRATES	BASE	PRIMER REQUIRED	REINFORCEMENT	TRAINING
		N/A	5+			Most common roofing substrates	SOLVENT			



1-2kg/m²



ACRYPOL +

Acrypol + known as the original waterproof coating, can be applied during damp weather conditions and still provide a long-term solution to waterproofing problems, including flat roof repair.



ACRYPOL +.

Acrypol+ is a total roof coating waterproof system developed to refurbish failed industrial, commercial or domestic flat roofs and is also ideal for general property maintenance as well as patch repairs. Brush applied as a semi liquid paste; it dries to form an ultra-tough, seamless flexible overlay.

Size:	Colour:	Box Qty:	Prod.Codes:
2.5kg	Grey	6	ACRYPOL/2.5
5kg	Grey	4	ACRYPOL/5
20kg	Grey	1	ACRYPOL/20
5kg	Black	4	ACRY/FSOLB/5
20kg	Black	1	ACRY/FSOLB/20
2.5kg	White	6	ACRY/FSOLW/2.5
5kg	White	4	ACRY/FSOLW/5
20kg	White	1	ACRY/FSOLW/20

ACRYPOL SCRIM.

Used when extra reinforcement is required, for example cracks in corrugated asbestos, gutters, splits in felt and asphalt roofing.

Size:	Box Qty:	Prod.Codes:
15cmx20m	5	ACRY/SCRIM/15

ACRYPOL+ Acrylic Roof Coating

Known as the original waterproof coating, Acrypol+ can be applied during damp weather and still provide a long-term solution to waterproofing problems, including flat roof repair.

NEW DECK	OVERLAY	WARRANTY (YEARS)	LIFE EXPECTANCY (YEARS)	TRADE / PROFESSIONAL USE	DRY USE	SUBSTRATES	BASE	PRIMER REQUIRED	REINFORCEMENT	TRAINING
		N/A	5+			Most common roofing substrates	SOLVENT			



1 kg/m²



CROMAPOL



Web page link

ACRYPOL +



Web page link

Hydrosil is a highly reflective Fluid Applied Professional Grade Silicone Coating System used to coat all existing roofing substrates. Silicone durability – excellent long term resistance to natural weathering including extreme temperatures, UV, rain & snow.

HYDROSIL SEAM SEALER & DETAILER.

Multi purpose product.

A premium silicone based multi purpose detailer for protection of seams, penetrations and fasteners on various roofing substrates. Forms a durable, breathable and weatherproof barrier that is highly resistant to degradation from UV and natural weathering.

Size: 7.5L Box Qty: 1 Prod.Codes: **AHYDSIL/SSD**

HYDROSIL SILICONE ROOF COATING.

A high performance, moisture curing liquid applied premium silicone coating. With superior coverage, Hydrosil covers over one and a half times that of a standard PU coating. Fast curing, durable, watertight and weatherproof barrier, excellent UV resistance and foot trafficable in 24 hours are just some of the product benefits.

Size: 3.78L 18.9L Box Qty: 1 1 Prod.Codes: **AHYDSIL/501** **AHYDSIL/601**

HYDROSIL REINFORCEMENT ROLL.

A non-woven, spun bonded 100% polyester used with the Hydrosil Seam Sealer & Detailer to reinforce seams, penetrations, joints or transitions that are subjected to high shear.

Size: 150mm x 100m Box Qty: 1 Prod.Codes: **AHYDSIL/ROLL**

HYDROSIL Silicone Roof Coating

A high performance, moisture curing liquid applied premium silicone coating

NEW DECK	OVERLAY	WARRANTY (YEARS)	LIFE EXPECTANCY (YEARS)	TRADE / PROFESSIONAL USE	DIY USE	SUBSTRATES	BASE	PRIMER REQUIRED	REINFORCEMENT	TRAINING
		N/A	10+			Most common roofing substrates	SOLVENT			



1L / 1.25m²



Grey



18.9Ltr

3.78Ltr

The Metal-Kote fast acting formula is also a cost effective solution for bringing an entire roof back to life for just 40% of the cost of replacing it, and without the costly downtime.

METAL-KOTE.

Metal-Kote is a single coat, cold applied solution for renovating and waterproofing failing metal roofs. It can be applied directly in a single coat to combat flaking, rusting and peeling metal and plastic coated roofs, and requires no primer. The formula offers a 100% waterproofing formula and outstanding adhesion that can even fix tears in metal.

Size:	Colour:	PLT. Qty:	Prod.Codes:
20L	Grey	22	ACRY/GWG20



RUBBERCOAT.

A brush/roll on high performance coating that can be applied over many surfaces including concrete, masonry, wood, brick, metal foam and more.

Size:	Box Qty:	Prod.Codes:
3.78L	4	ARC/3.78
18.9L	1	ARC//18.9

RubberCoat
LIQUID RUBBER ROOF COATING

- Easy to apply - brush, roller or squeegee • Flexible seamless technology • Excellent UV, adhesion & chemical resistance • Protects & bonds to virtually any surface • Excellent freeze / thaw resistance • Resists cracking, chipping, peeling, impact & abrasion

HYDROSIL
Professional Grade 100% Silicone Roof Coating



Web page link

RubberCoat
LIQUID RUBBER ROOF COATING



Web page link

METALKOTE
Waterproof Coating For Metal Roofs



Web page link

BITUMEN RANGE

ROOFING EMULSION.

Bituminous emulsion containing fillers which provides all over waterproofing of roofs, leaving a smooth finish.

Size:	Box Qty:	Prod.Codes:
25L	1	ARE/601

BLACK BITUMEN PAINT.

General purpose paint for waterproofing and weather protection of steelwork and concrete.

Size:	Box Qty:	Prod.Codes:
1L	12	ABP/101
2.5L	6	ABP/251
5L	4	ABP/501
25L	1	ABP/601

COLD GRITTING ADHESIVE.

Cold applied bituminous adhesive for bonding chippings to flat or low pitched roofs.

Size:	Box Qty:	Prod.Codes:
5L	4	ACG/501
25L	1	ACG/601

HOT GRITTING ADHESIVE.

Bituminous adhesive for bonding chippings to flat or low pitched roofs. (NOT PICTURED)

Size:	Box Qty:	Prod.Codes:
25L	1	AHG/601

ALUMINIUM PAINT.

Bright aluminium reflective coating suitable for application to bituminous roofing substrates. Premium Grade also available.

Size:	Box Qty:	Prod.Codes:
2.5L	6	AAC/251
5L	4	AAC/501T
25L	1	AAC/601

PREMIUM GRADE VERSION

Size:	Box Qty:	Prod.Codes:
5L	4	AAP/501
25L	1	AAP/601

BITUMEN PRIMER.

Low viscosity bitumen primer for use on porous surfaces before any remedial roof treatment, including pour and roll and torch-on felt applications. Quick Drying (QD) version also available.

Size:	Box Qty:	Prod.Codes:
1L	12	APR/101
2.5L	6	APR/251
5L	4	APR/501
25L	1	APR/601

QUICK DRYING VERSION

Size:	Box Qty:	Prod.Codes:
5L	4	AQP/501
25L	1	AQP/601

Please note: Colours shown against products are simply a representation and are not exact due to limitations of print processes. For exact colours please request samples.



Web page link

CROMAPRUF.

General purpose rubberised bitumen emulsion used on walls and floors to prevent water ingress and dampness from the ground. Can also be used on roofs and as wood block floor adhesive.

Size:	Box Qty:	Prod.Codes:
5L	4	ACP/501
22.5L	1	ACP/601

ALL WEATHER ROOF COAT.

Filled bituminous solution for over-all waterproofing of roofs. Can be applied to dry surfaces all year round.

Size:	Box Qty:	Prod.Codes:
2.5L	6	AAW/251
5L	4	AAW/501
25L	1	AAW/601

HEAVY DUTY VERSION

Size:	Box Qty:	Prod.Codes:
25L	1	AAW/601HD

TROWEL MASTIC.

Heavy body bituminous mastic for sealing cracks and splits in roofing substrates and gutters.

Size:	Box Qty:	Prod.Codes:
1L	12	ATM/101
2.5L	6	ATM/251
5L	4	ATM/501

ROOFING FELT ADHESIVE.

Cold applied, bituminous adhesive for bonding successive layers of roofing felt.

Size:	Box Qty:	Prod.Codes:
1L	12	AFA/101
2.5L	6	AFA/251
5L	4	AFA/501
25L	1	AFA/601

Bitumen roof compounds continue to represent exceptional value for flat roof waterproofing and emergency repairs.

Our range covers every possible application.

TRADITIONAL FELTS



Cromatorch.

Cromatorch is a traditional bitumen torch on felt. Quick to apply in both wet and dry conditions. For application to concrete, timber and metal deck flat roofs, and can be used as the covering for garages, sheds and flat roof extensions.

SBS 2kg Underlay Sand

Weight:	Roll Length:	Plt. Qty:	Prod.Codes:
32kg	16m x 1m	30	ECAUSBS/2

SBS 2kg Double Glossy Underlay Black

Weight:	Roll Length:	Plt. Qty:	Prod.Codes:
32kg	16m x 1m	28	ECAUSBS/2G

SBS 3mm Double Glossy Underlay Black

Weight:	Roll Length:	Plt. Qty:	Prod.Codes:
36kg	12m x 1m	25	ECAUSBS/2G3M

SBS 4kg Sand

Weight:	Roll Length:	Plt. Qty:	Prod.Codes:
32kg	8m x 1m	30	ECASG/4

SBS Mineral 4.5kg Green

Weight:	Roll Length:	Plt. Qty:	Prod.Codes:
36kg	8m x 1m	25	ECAGG/4.5

SBS Slate 4.5kg Black

Weight:	Roll Length:	Plt. Qty:	Prod.Codes:
36kg	8m x 1m	25	ECABG/4.5

Perforated Torch On Underlay

Weight:	Roll Length:	Plt. Qty:	Prod.Codes:
36kg	20m x 1m	25	ECAGP/800



Traditional Felts.

1F U/Slating

Weight:	Roll Length:	Plt. Qty:	Prod.Codes:
22.5kg	15m x 1m	36	B1F/22

Cap Sheet Green Mineral

Weight:	Roll Length:	Plt. Qty:	Prod.Codes:
34kg	10m x 1m	25	BCS/36

Standard Bonding Felt

Weight:	Roll Length:	Plt. Qty:	Prod.Codes:
18kg	10m x 1m	42	BSB/18
36kg	20m x 1m	25	BSB/36

Shedfelt Green

Weight:	Roll Length:	Plt. Qty:	Prod.Codes:
10kg	5m x 1m	72	BSF/10
20kg	10m x 1m	49	BSF/20
40kg	20m x 1m	25	BSF/40

Shedfelt Sand

Weight:	Roll Length:	Plt. Qty:	Prod.Codes:
7kg	5m x 1m	80	BSF/7
14kg	10m x 1m	48	BSF/14

3B Bonding Felt

Weight:	Roll Length:	Plt. Qty:	Prod.Codes:
36kg	20m x 1m	25	C3B/36

3H Vent Base Layer

Weight:	Roll Length:	Plt. Qty:	Prod.Codes:
34kg	20m x 1m	25	C3H/34D

5U Eaves Protector Strips

Weight:	Roll Length:	Plt. Qty:	Prod.Codes:
14.5kg	16m x 500mm	60	D5U/15
9.66kg	16m x 333mm	90	D5U/330

Please note: Colours shown against products are simply a representation and are not exact due to limitations of print processes. For exact colours please request samples.



Web page link

Protect1F®.

A high performance non breathable roof underslating which gives major benefits over plastic and traditional 1F bitumen based underslating felt in Dark Grey.

Size:	Plt. Qty:	Prod.Codes:
1mx15m	160	TPF/15
1mx45m	56	TPF/45

Oxidised Bitumen.

Ideal for bonding traditional roof felts. Grade 95/25 in Dark Grey

Size:	Plt. Qty:	Prod.Codes:
23kg	50	NOX/23



Cromar Modi-Torch.

High performance SBS modified torch-on capsheet with a low temperature flexibility.

5kg Capsheet Black

Weight:	Roll Length:	Plt. Qty:	Prod.Codes:
40kg	8m x 1m	25	EMTM/8M36

5.5kg Capsheet Black

Weight:	Roll Length:	Plt. Qty:	Prod.Codes:
44kg	8m x 1m	25	EMTM/8M44

Cromasol.

A high performance reflective paint for use on bituminous surfaces, ideal for use on roofs that are subject to standing rain water.

Size:	Box Qty:	Colour	Prod.Codes:
5kg	4	White	ACS/501
20kg	1	White	ACS/601
5kg	4	Grey	ACSG/501
20kg	1	Grey	ACSG/602

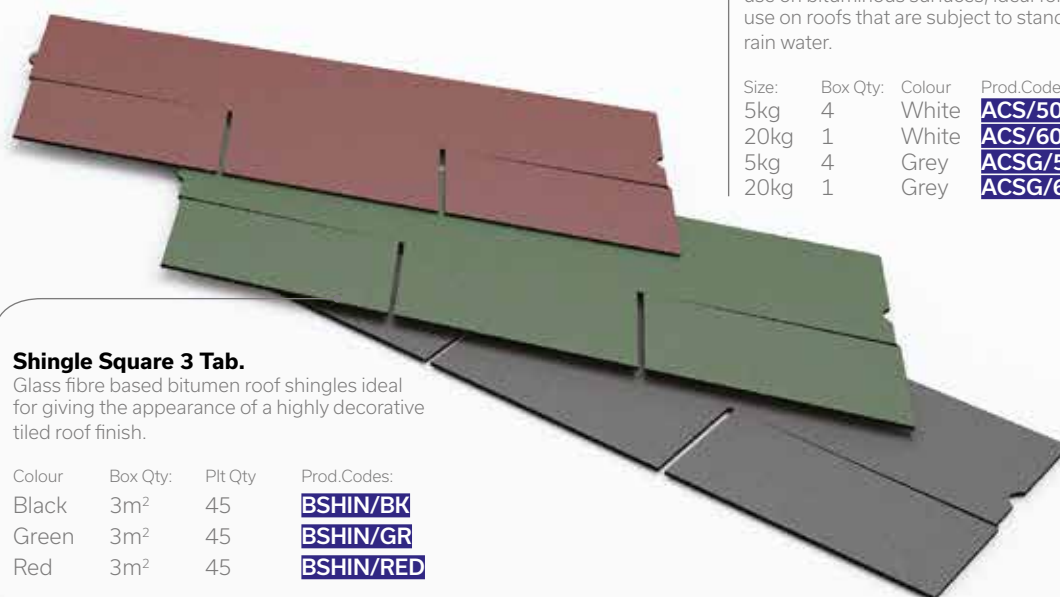

Shingle Square 3 Tab.

Glass fibre based bitumen roof shingles ideal for giving the appearance of a highly decorative tiled roof finish.

Colour	Box Qty:	Plt Qty	Prod.Codes:
Black	3m ²	45	BSHIN/BK
Green	3m ²	45	BSHIN/GR
Red	3m ²	45	BSHIN/RED

A comprehensive range of SBS, APP and traditional roofing felts. Our products cover all specification options, whether the need is for high performance, torch-on or traditional pour and roll felts.



Please note: Colours shown against products are simply a representation and are not exact due to limitations of print processes. For exact colours please request samples.



Web page link



**UK UK
CA NI**



7 NFRC
LEADING ROOFING EXCELLENCE



The Vent3 Air from Cromar is an advanced, multi-layer design breather membrane designed for use in both warm and cold roof constructions. Engineered to provide superior ventilation allowing much needed air flow, moisture control, and durability, Vent3 Air ensures a healthier and more energy-efficient building envelope.

VENT3® AIR - 170GSM.

The use of VENT3® AIR roofing membranes can lead to several benefits, including improved energy efficiency, reduced risk of moisture-related issues, increased roof lifespan, and enhanced indoor comfort.

Size:	Colour:	Pallet Qty:	Prod.Codes:
1x50m	Orange	30	TV3/50AIR



UV and water resistant
Exceeds the BS EN 12114 for air permeability
No vapour control layer needed
Eliminates the need for additional ventilation

Windzone
345mm
Without Taping

250mm
Without Taping

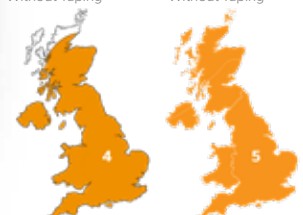

VENT3[®] Breathable membranes

A range of high performance breathable roof underlays for cold and warm roof application.

VENT3[®] PRO - 165GSM .

A heavyweight high performance breathable membrane suitable for cold and warm roof applications, providing huge benefits over traditional roof underlays.

Size:	Colour:	Pallet Qty:	Prod.Codes:
1x25m	Green	80	TV3P/25
1x50m	Green	56	TV3P/50
1.5x50m	Green	48	TV3P/75

VENT3[®] - 135GSM .

A high performance breathable membrane ideal for cold and warm roof application.

Size:	Colour:	Pallet Qty:	Prod.Codes:
1x15m	Blue	110	TV3/15
1x25m	Blue	104	TV3/25
1x50m	Blue	54	TV3/50
1.5x50m	Blue	54	TV3/75

VENT3[®] - DOUBLE SIDED BREATHER TAPE.

A modified acrylic, high strength adhesive tape used to create air-tight laps between successive layers of underlay / vapour barrier membrane.

Size:	Box Qty:	Prod.Codes:
60mm x 25m	4	TC3/TAPE

Please note: Colours shown against products are simply a representation and are not exact due to limitations of print processes. For exact colours please request samples.



Web page link

VENT3® LIGHT - 95GSM .

A lightweight breathable roof underlay for cold and warm roof applications, providing major benefits over traditional roof underlays.

Size:	Colour:	Pallet Qty:	Prod.Codes:
1x15m	Grey	144	TV3L/15
1x25m	Grey	104	TV3L/25
1x50m	Grey	56	TV3L/50
1.5x50m	Grey	56	TV3L/75

VENT3® CLASSIC - 115GSM .

A breathable roof underlay for cold and warm roof applications which give major benefits over traditional roof underlays.

Size:	Colour:	Pallet Qty:	Prod.Codes:
1x15m	Grey	144	TV3C/15
1x25m	Grey	104	TV3C/25
1x50m	Grey	56	TV3C/50
1.5x50m	Grey	56	TV3C/75



- Cold & Warm roof application
- 3 layer spun-bonded membrane
- BS5534 Compliant
- High performance & flexibility
- Excellent tensile strength
- No gusting wind noise
- UV stable for up to 3 months
- Excellent nail tear resistance



Web page link



VENT3[®] EXCEL190

Weighing in at 190gsm, this premium roofing felt is BS5534 compliant, ensuring it meets the highest standards of wind uplift resistance and weather protection.

Size: 1x50m Colour: Light Blue Pallet Qty: 56 Prod Codes: **TV3E/50**



Conforms to NHBC guidelines Suitable for use in accordance of the BS 5250:2021

Windzone
345mm
Without Taping



250mm
Without Taping



Please note: Colours shown against products are simply a representation and are not exact due to limitations of print processes. For exact colours please request samples.



Web page link

Premium Lightweight Thermal Roof Slate

- BS476 Part 3 Fire Resistance
- BRE Wind and Rain Tested
- UV Weathering Resistant
- 20-Year Warranty

RIDGE & HIP SLATE.

225mm visible face, approx. 5 hip ridge per 1m run. Size: 300mm x 490mm and is coloured Slate Grey.

Box Qty: 30 Prod. Codes: **R/SLATEHIP**



ANGLED RIDGE SLATE.

5 hip ridge per 1m run. Size: 240mm x 445mm and is coloured Slate Grey.

Box Qty: 5/LM Prod. Codes: **R/SLATERIDGEASG**



SLATE VERGE.

The Cromar dry fix slate verge is the perfect solution for mortar free slate verges and provides an all weather solution. Coloured in black.

Box Qty: 10 Size: 2m Prod. Codes: **R/SLATEVERGE**

SLATE VERGE CONNECTOR
10 N/A **R/SLATEVERGE/CON**



Ideal for:
Conservatories, Annexes, Sheds,
Garages, Lean-tos & Extensions

CROMASLATE.

BS476 Part 3 Fire BRE Wind & Rain UV Weathering 20 year warranty 15 slates per m² when set at 200mm gauge. Size: 330mm x 495mm coloured Slate Grey.

Box Qty: 15 Prod. Codes: **R/SLATESG**

~~PRO-RIDGE~~

Universal Ridge & Hip System

Cromar ProRidge Universal Ridge & Hip kit is suitable for ridge and hip applications and works with most ridge tiles – the quicker and easier alternative to mortar.

BS 8612:
Dry Fixed Ridge, Hip and Verges
Systems for Slating and Tiling



PRO RIDGE UNIVERSAL.

Suitable for ridge and hip application, works with most ridge tiles - the quicker and easier alternative to mortar.

Size	Plt. Qty:	Prod.Codes:
3m	96	URK/3M
6m	96	URK/6M

PRO RIDGE PLUS.

Suitable for use with clay ridge tiles, contains the same components as the Universal ProRidge Kit but with additional ridge tile clamps, screws, ridge unions and union clips.

Size	Plt. Qty:	Prod.Codes:
6m	48	URK/6MP



Also Available: HIP TRAY 1.2m.

Size	Box Qty:	Prod.Codes:
1.2m	10 Trays	UR/TRAY

HIP TRAY PACK 6m.

Hip accessory kit, each size containing the following:
20 x Hip Clips 6 x 1.2m Hip Tray

Size	Box Qty:	Prod.Codes:
6m	1	URK/HIP

Please note: Colours shown against products are simply a representation and are not exact due to limitations of print processes. For exact colours please request samples.

A premium, universal dry verge system, no need for separate left or right hand verges anymore. With this quick fit design there is no need for using mortar, and roof tiles are held firm even in strong winds

CROMAVERGE.

A premium, universal dry verge system, no need for separate left or right hand verges anymore. With this quick fit design there is no need for using mortar, and roof tiles are held firm even in strong winds.

Colour:	Box Qty:	Prod.Codes:
Grey	20	UR/VERGG
Brown	20	UR/VERGBR
Terracotta	20	UR/VERGT
Black	20	UR/VERGBL

CROMAVERGE STARTER KIT.

Colour:	Box Qty:	Prod.Codes:
Grey	20	UR/STARTG
Brown	20	UR/STARTBR
Terracotta	20	UR/STARTT
Black	20	UR/STARTBL

CROMAVERGE CENTRE CAPS.

Manufactured from UV stabilised and recyclable polypropylene these centre caps are quick and easy to fix to the apex, with no mortar required. Compatible with Cromaverge and Dry Verge Systems.

Kind:	Colour:	Box Qty:	Prod.Codes:
Round	Grey	10	UR/CAPG
Angled	Grey	10	UR/CAPAG
Round	Brown	10	UR/CAPBR
Angled	Brown	10	UR/CAPBR
Round	Terra	10	UR/CAPT
Angled	Terra	10	UR/CAPT
Round	Black	10	UR/CAPBL
Angled	Black	10	UR/CAPBL

PRORIDGE
Universal Ridge & Hip System



Web page link

CROMAVERGE
PREMIUM UNIVERSAL DRY VERGE



Web page link

GRP VALLEY TROUGHS



Manufacture assured
to BS EN ISO 9001

V-Flow valley troughs can be used with clay or concrete tiles or slate roofs, as well as profiled GRP or metal roofs. Options are available for wet or dry fixing (with or without mortar).



STANDARD VALLEY TROUGH (DOUBLE LAP) SLATE/TILES.

Size: 330mm

Box Qty: 10

Prod.Codes: **GSVT1**



PRO VALLEY 55mm.

Size: 400mm

Box Qty: 10

Prod.Codes: **GDFVTUB55**



PRO VALLEY 80mm.

Size: 400mm

Box Qty: 10

Prod.Codes: **GDFVTUB80**



PRO VALLEY 105mm.

Size: 400mm

Box Qty: 10

Prod.Codes: **GDFVTUB105**



90 DEGREE TOP CLOSURE.

Piece for 70mm GDFVT110

Box Qty: 10

Prod.Codes: **GDFCD110**



TOP CLOSURE.

for use with GDFVTC110

Size: 310mm

Box Qty: 10

Prod.Codes: **GDFVTC110**



DF VALLEY TROUGH.

Size: 400mm

Box Qty: 10

Prod.Codes: **GDFVT110**



PRO VALLEY BONDING STRIP 100mm.

Size: 225mm

Box Qty: 10

Prod.Codes: **GDFBSUB100**



PRO VALLEY BONDING STRIP 70mm.

Size: 225mm

Box Qty: 10

Prod.Codes: **GDFBSUB70**



90 DEGREE TOP CLOSURE.

Piece for 70mm GDFVT70

Box Qty: 10

Prod.Codes: **GDFVTC70**



EAVES CLOSURE.

Piece for GDFVT70

Box Qty: 10

Prod.Codes: **GDFS110**



DF VALLEY TROUGH.

(Natural / Man made slate)

Size: 400mm

Box Qty: 10

Prod.Codes: **GDFVT70**



DF BONDING STRIP.

or use with natural/slate man made

Size: 225mm

Box Qty: 10

Prod.Codes: **GDFBS70**



DF BONDING STRIP.

(Concrete/Clay tile)

Size: 225mm

Box Qty: 10

Prod.Codes: **GDFBS110**



NARROW VALLEY TROUGH.

(Single lap tile) Over Batten Fix

Size: 360mm

Box Qty: 10

Prod.Codes: **GTB13**



STANDARD VALLEY TROUGH.

(Single lap tile) Over Batten Fix

Size: 400mm

Box Qty: 10

Prod.Codes: **GTB14**



STANDARD VALLEY TROUGH.

(Slate or tile) Under Batten

Size: 400mm

Box Qty: 10

Prod.Codes: **GTF14**



SECRET JOINT STRIP.

Bonded in channel

Size: 216mm

Box Qty: 10

Prod.Codes: **GJS1**



ABUTMENT SOAKER.

Size: 140mm

Box Qty: 10

Prod.Codes: **GAS1**

Please note: Colours shown against products are simply a representation and are not exact due to limitations of print processes. For exact colours please request samples.

1 3-IN-1 OVERFASCIA EAVES PROTECTOR COMB FILLER.

The fast and easy way to ventilate and protect at the eaves, consisting of a 1000mm over fascia vent with integrated underlay support tray and eaves comb filler.

Size: 100mm
Pack Qty: 10
Prod.Codes: **R/OVEP-310**

3 Over Fascia Vent 10mm & 25mm.

Available in 2 ventilation capacities. Allows an air stream in to the roof void between the felt and fascia board.

Size: 100mm X 23mm
Pack Qty: 40
Prod.Codes: **R/OFV10-1000**
R/OFV25-1000

2 EAVES COMB FILLER.

A physical barrier that prevents birds, bats and insects entering the roof void between the felt and tiles and causing nesting and infestation problems.

Size: 1000mm
Pack Qty: 300
Prod.Codes: **R/BC-1**

4 2-IN-1 OVERFASCIA EAVES PROTECTOR COMB FILLER.

Size: 100mm X 1m
Pack Qty: 40
Prod.Codes: **R/OVEP-210**

GRP Valley Troughs.



Web page link



1.2m HIP TRAY.

Box Qty: 10
Prod.Codes: **UR/TRAY**

VENT3® - UNDERLAY SUPPORT TRAY.

A support tray to ensure any underlay is not carried into the gutter, and prevents water ponding behind the fascia. Therefore reducing long term maintenance to the eaves of a building.

Size: 1.5m
Pack Qty: 10
Prod.Codes: **IUST/1MAN**
1.5m (50mm)
Pack Qty: 10
Prod.Codes: **IUST/1MAN50MM**



CONTINUOUS RAFTER TRAY.

Allows a constant flow of air between the loft space and outside meaning built-up moisture can escape. 6m Length.

Size: 300mm
Box Qty: 5
Prod.Codes: **R/RPV-300**
400mm
Box Qty: 5
Prod.Codes: **R/RPV-400**
600mm
Box Qty: 5
Prod.Codes: **R/RPV-600**
800mm
Box Qty: 5
Prod.Codes: **R/RPV-800**

5U EAVES PROTECTOR STRIP.

A support strip to ensure any underlay is not carried into the gutter, and prevents water ponding behind the fascia. Therefore reducing long term maintenance to the eaves of a building. 16m roll.

Size: 330mm
Box Qty: -
Prod.Codes: **D5U/330**
500mm
Box Qty: -
Prod.Codes: **D5U/15**

DISC SOFFIT VENT.

Easy to install circular vent provides eaves ventilation through the soffit for new build or re-roofing. Size 2500mm²

Colour: Brown
Box Qty: 100
Prod.Codes: **R/DSV2000B**
Tan
Box Qty: 100
Prod.Codes: **R/DSV2000T**
White
Box Qty: 100
Prod.Codes: **R/DSV2000W**
Black
Box Qty: 100
Prod.Codes: **R/DSV2000BL**

LEAD REPLACEMENTS

LEADAX ORIGINAL .

Since its launch in 2018 Leadax has grown to be one of the most popular lead alternatives on the market. With numerous benefits over Lead, and other lead replacements, it is the obvious choice. **6m long rolls.**

Size:	Colour:	Pallet Qty:	Prod.Codes:
150mm	Grey	198	KLD/150
200mm	Grey	165	KLD/200
250mm	Grey	132	KLD/250
300mm	Grey	99	KLD/300
400mm	Grey	66	KLD/400
450mm	Grey	66	KLD/450
600mm	Grey	66	KLD/600
1000mm	Grey	33	KLD/1000

LEADAX EASY FA.

Leadax Easy FA is the fully self-adhesive lead replacement in the product family Leadax Flashing. Leadax Easy FA has no harmful effects on people's health and the environment. A second generation lead replacement that's very light to use. Leadax Easy FA can easily be applied by hand and only has to be pushed down with a roller very lightly. Leadax Easy FA is extremely thin, yet extremely strong. **5m long rolls.**

Size:	Colour:	Pallet Qty:	Prod.Codes:
150mm	Grey	198	KLDE/150
250mm	Grey	132	KLDE/250
300mm	Grey	99	KLDE/300
450mm	Grey	66	KLDE/450

LEADAX SEALANT.

An all purpose hybrid sealant & adhesive for fixing Leadax to the base material or for overlapping. Provides good adhesion to lead & roofing substrates.

Size: 290ml Box Qty: 12

Prod.Codes:
M/LEADAXSEAL

LEAD SEALANT.

A grey low modulus, neutral cure, fast curing lead sealant, specifically designed for use with metals such as lead, galvanised steel etc. Ideal for stopping weather ingress, tile lift and noise.

Size: 300ml Box Qty: 25 Prod.Codes:
MLED-MATE/031

PATINATION OIL .

Specially developed to reduce unsightly staining and provides a pleasing appearance to newly applied lead sheet and flashings.

Size: 1L Box Qty: 10 Prod.Codes:
MPAT/101

LEADAX FIXING CLIPS.

For use with above ground masonry, Leadax fixing clips allow you to attach Leadax into masonry joints quickly and easily. Also suitable for use with lead.

Bag Qty: 50 Box Qty: 10 bags Prod.Codes:
KLD/CLIP50

MULTI-PURPOSE SCISSORS.

High quality, extra tough scissors for cutting Leadax to size quickly and easily.

Pack Qty: 1 Prod.Codes:
KLAD/SCISSORS

LEADAX ROLLER.

Rollers to allow easy moulding of Leadax around roof tiles or difficult profiles.

Box Qty: 1 Prod.Codes:
KLAD/ROLLER

LEADAX PENNY ROLLER.

Rollers to allow easy moulding of Leadax around roof tiles or difficult profiles.

Box Qty: 1 Prod.Codes:
KLAD/PENNYROLL

Please note: Colours shown against products are simply a representation and are not exact due to limitations of print processes. For exact colours please request samples.

All Weather Roofing System

LIQUID ROOF



Liquid Roof is a one-component, fast curing, polyurethane based waterproofing system for flat and pitched roofs. Applied in two coats by brush or roller, Liquid Roof creates a solid, seamless, waterproof membrane that remains permanently flexible, making it the ideal solution for new installations, the refurbishment of old or to overlay most common roofing substrates. Liquid Roof comes ready to use and is cold applied by brush or roller, using moisture in the air to cure meaning no additional catalyst is required. And what's more, it will cure in many weather conditions becoming completely rain resistant in just 10 minutes,

even if a pool of water forms on top of it. Suitable for use on a variety of substrates, Liquid Roof is compatible with concrete, mortar, stone, fibre cement, roof tiles and metals. Not only that but it can also be applied to wood, asphalt, roofing felt and bituminous coatings with the use of full reinforcement in the form of Sikalastic® Fleece-120.



Liquid Roof

SGAN	SIZE	COLOUR	QTY	BARCODE
511382	7 kg	Slate Grey	4	5029347614164
511383	21 kg	Slate Grey	1	5029347614171

Sikalastic® Fleece-120

SGAN	SIZE	QTY	BARCODE
97480	1 m x 50 m	1	7612894436402
97481	0.3m x 50m	1	7612894436419



LEAD-FREE PLUS.

Is a high performance, economical aluminium self adhesive flashing suitable for use as an alternative to traditional lead in both flat and pitched roof applications. **5m long rolls.**

Size:	Colour:	Pallet Qty:	Prod.Codes:
150mm	Grey	288	KLFP/150
300mm	Grey	160	KLFP/300
450mm	Grey	70	KLFP/450

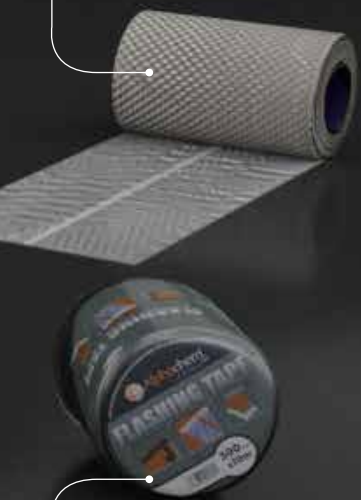

FLASHING TAPE.

High quality, self adhesive bitumen coated, heavy duty, lead look finish tape for trade use. Available in a wide range of widths in **10m long rolls.**

Size:	Box Qty:	Prod.Codes:
50mm	6	KFB/50/N
100mm	6	KFB/100/N
150mm	4	KFB/150
225mm	2	KFB/225
300mm	2	KFB/300/N
450mm	1	KFB/450
600mm	1	KFB/600



A SIKA COMPANY

Sika's popular range of adhesives and sealants is now available through Cromar, giving customers easier access to trusted, high-performance solutions for construction and roofing projects. This expansion strengthens Cromar's offering with proven Sika quality across key product lines.



Sealant and Adhesive

Sika® Stixall®

Sika® Stixall® is a combined adhesive and sealant, based on hybrid polymer technology, with extreme power to both bond and seal nearly everything in almost all conditions, even underwater and in the rain! Available in both cartridges and easi-squeeze tubes. CE Marked.



Solvent Free Adhesive

Sika® Instant Nails

Instant Nails is a high strength, solvent free, gap filling, multi use adhesive that provides a quick grab and replaces mechanical fixings in many home improvement applications. Dries white and may be overpainted if required.



Solvent Based Adhesive

Sika® Pinkgrip® Dry Fix FR



Pinkgrip Dry Fix FR is a revolutionary type of fast curing, adhesive foam that has been specially developed for the rapid installation of Plasterboard, Insulation Boards and other sheet materials such as Roof Decking and Floorboards. The Dual Flow system means that it can be applied using the nozzle provided or attached to the Dry Fix Applicator Gun. Pinkgrip Dry Fix FR provides significant labour saving and convenience benefits when compared to traditional dry wall adhesives. It will bond to most common building substrates; can be applied horizontally or vertically to the board, wall or battens/beams. Dry Fix FR conforms to the requirement of EN13501-1 Class E for fire rating.

Solvent Based Adhesive

Sika® Pinkgrip®



Sika® Pinkgrip® will stick just about anything on a building site that needs sticking. Its amazing grabbing strength not only removes the need to pin under the workpiece to prevent slumping, but its revolutionary initial 'Direct Bond' eliminates the need for double stick methods. Pinkgrip can be used inside and outside and adheres to just about every building substrate.



Scan the QR code to learn more about Sika's range of adhesives and sealants, now available from Cromar. Get product info, specs.



Multi-Use Wipes

Sika® Wonder Wipes

Multi-Use Wonder Wipes are specially formulated to clean hands, tools and surfaces from wet and semi-cured paint, sealant, adhesive, bitumen, expanding foam, oil, grease and even silicone. Useful when there is no water on site. Wonder Wipes contain a powerful anti-bacterial additive that is tested by an independent laboratory to BSEN 1276:2009.



Hybrid Polymer Adhesive

Sika® Multi Stick

Sika® Multi Stick is a superior grab adhesive with the ability to bond virtually anything to everything in both wet and dry conditions, even underwater or in the rain. With incredible initial grab, high bonding strength, and almost limitless applications, no tradesman should be without a tube of this next generation adhesive. Think of any bonding application and it is virtually certain Multi-Stick will handle it with ease.



Adhesive, Sealant and Filler

Sikaflex® EBT+

A multi-purpose, permanently- elastic, one-part, polyurethane adhesive and sealant. Sikaflex® EBT+ bonds to all common building materials; its excellent grab and gap filling properties makes it ideal for use in a wide range of building and maintenance applications.

Compatible as a trim adhesive for the Cromar GRP Trims.



Plaster Bonding Agent

Sika® Blue Grit

Sika® Blue Grit is a high performance, plasterers grip coat bonding agent specifically designed to provide an improved key to smooth surfaces. Containing a fine aggregate, it provides a mechanical key to backgrounds such as plaster, concrete, painted surfaces, textured surfaces and ceramic tiles. One coat application, coloured blue to indicate coverage.



SIKA UK AND IRELAND DISTRIBUTION

INDEPENDENT MERCHANTS

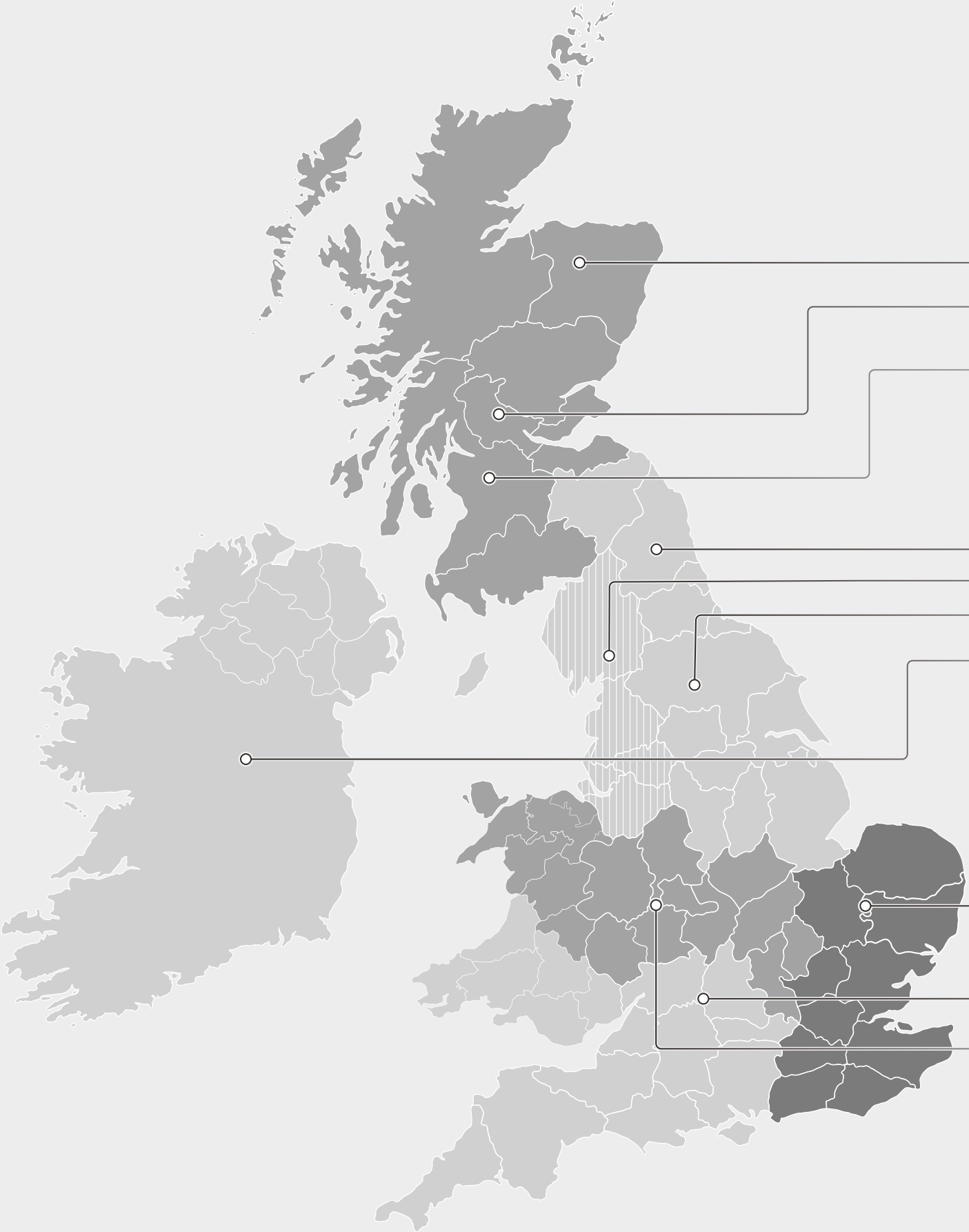

Wayne Angelo
Head of Sales - Roofing Distribution
07522 235 312
angelo.wayne@uk.sika.com

Kenny Moore
National Sales Manager - Scotland
07768 873 477
moore.kenny@uk.sika.com

SCOTLAND

Anna Paton
Business Development Manager
07970 122 216
turner.anna@uk.sika.com

Postcodes covered
DG G KA M L

SCOTLAND

Adelle Galloway
Business Development Manager
07884 814 074
galloway.adelle@uk.sika.com

Postcodes covered
EH FK KY PA TD

SCOTLAND

Odin Anderson
Business Development Manager
07900 057 413
anderson.odin@uk.sika.com

Postcodes covered
AB DD HS IV K W PH ZE

IRELAND

Niall McCarthy
Regional Sales Manager
00353(0) 83 0102 991
mccarthy.niall@uk.sika.com

ENGLAND NORTH WEST

Jake Senior
Regional Sales Manager
07903 155 629
senior.jake@uk.sika.com

Postcodes covered
BD DN HU LN PE TD F
DH HD HX LS S TS YO
DL HG IM NE SR W

ENGLAND NORTH EAST

Conrad Henderson
Business Development Manager
07903 155 612
henderson.conrad@uk.sika.com

Postcodes covered
BB CH FY M SK W
BL C L OL W N
CA W LA PR A

ENGLAND NORTH

Gareth Kitchen
Key Account Manager
07794 363 027
kitchen.gareth@uk.sika.com

Postcodes covered
BB C DN HX LS PE TD F
BD W FY IM M PR TS W
BL DE HD L NE S W N
CA DH HG LA NG SK A YO
CH DL HU LN OL SR W

WALES / MIDLANDS

Danny Wall
Regional Sales Manager
07929 607 078
wall.danny@uk.sika.com

Postcodes covered
B H LL G PE W W
CV R M N ST R V
DE LD K N SY W
DY LE N OX TF S

WALES / ENGLAND SOUTH

John Bain
Regional Sales Manager
07747 136 869
bain.john@uk.sika.com

Postcodes covered
BA CF GL PL SN TA
BH DT NP PO SO TQ
BS EX OX SA SP TR

ENGLAND SOUTH

Grahame Wratten
Regional Sales Manager
07812 582 656
wratten.grahame@uk.sika.com

Postcodes covered
AL CM CV EC HA JE ME NW RM SM TN WC WV
BN CO DA EN HP KT MK PO SE SO TW WD
BR CR DE GU IG LN N RG SG SS UB WR
CB CT E GY IP LU NR RH SL SW W WS

SCAN HERE TO ACCESS OUR FULL
BUILDING PRODUCTS GUIDE



BUILDING / CONSTRUCTION PRODUCT GUIDE

